

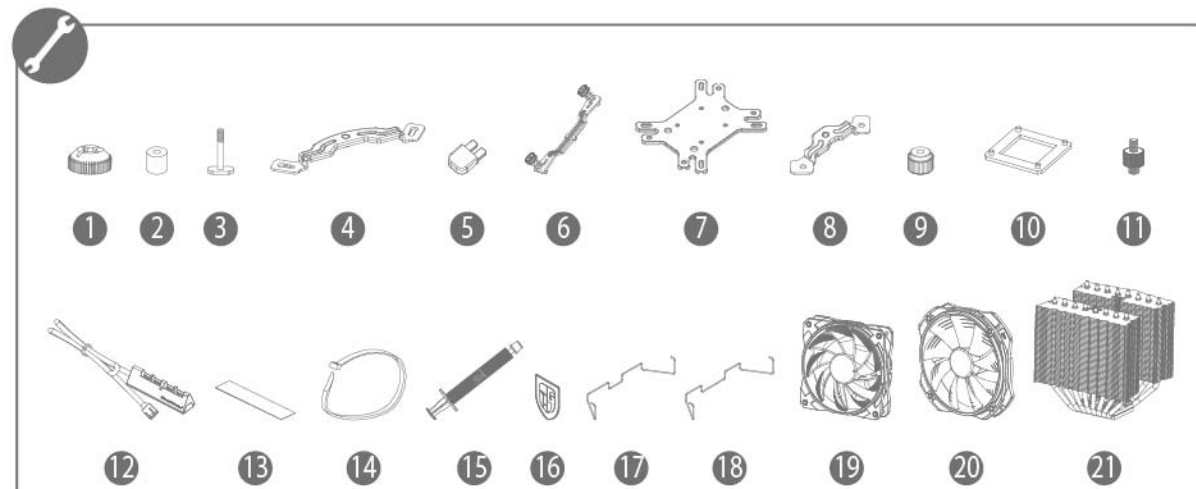

ASSASSIN II

User manual



1	Nut A	4 pcs	2	Insulation Pillar A	4 pcs	3	Screw Bolt	4 pcs	4	Mounting Bracket(Intel)	2 pcs	5	De-Vibration Buckle	4 pcs
6	Retention Plate	1 pc	7	Back Plate	1 pc	8	Mounting Bracket(AMD)	2 pcs	9	Nut B (For LGA775 only)	4 pcs	10	Insulating Washer (For LGA775 only)	1 pc
11	Double-screw Bolt	4 pcs	12	Fan Hub	1 pc	13	3M Sticker	1 pc	14	Cable Tie	1 pc	15	Thermal Grease	1 pc
16	Metal Logo Sticker	1 pc	17	Wire Clip-120	2 pcs	18	Wire Clip-140	2 pcs	19	120mm Fan	1 pc	20	140mm Fan	1 pc
21	Heatsink Set	1 pc												

Note for Fan Hub:

● Fan Hub

Fan Hub
Fan hub can support 4 fans to power with PWM function, but the speed of only the fan powered by the white color port can be checked by motherboard software.

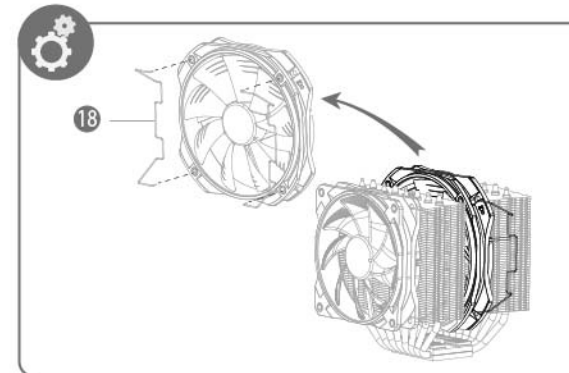

INTEL LGA1366 LGA1155 LGA1150 LGA775 Installation

Back plate installation (Intel)

1. Mounting Bracket(Intel) (4) and De-Vibration Buckle (5) are attached to the back plate (7).

2. The back plate (7) is installed onto the motherboard, secured with Nut A (1) and Insulation Pillar A (2).

3. The fan hub (12) is attached to the back plate (7) using a Cable Tie (14) and Wire Clips (17, 18).

4. The fan hub (12) is connected to the motherboard's power header.

5. The fan (19 or 20) is mounted onto the heatsink set (21) using a Double-screw Bolt (11) and Nut B (9).

AMD FM2+ FM2 FM1 AM3+ AM3 AM2+ AM2 Installation

Back plate installation (AMD)

1. Remove the back plate from the motherboard.

2. Mount the AMD Mounting Bracket (8) onto the motherboard using Insulation Pillar A (2) and Nut A (1).

3. Attach the De-Vibration Buckle (5) to the AMD Mounting Bracket (8).

4. Mount the fan (19 or 20) onto the heatsink set (21) using a Double-screw Bolt (11) and Nut B (9).

INTEL LGA2011 LGA2011-v3 Installation

Mounting Holes Illustration

1. Mounting Bracket(Intel) (4) and De-Vibration Buckle (5) are attached to the back plate (7).

2. The back plate (7) is installed onto the motherboard, secured with Nut A (1) and Insulation Pillar A (2).

3. The fan hub (12) is attached to the back plate (7) using a Cable Tie (14) and Wire Clips (17, 18).

4. The fan hub (12) is connected to the motherboard's power header.

5. The fan (19 or 20) is mounted onto the heatsink set (21) using a Double-screw Bolt (11) and Nut B (9).

Appearance Patent No.: 20148.007.16845
 Brands and designs are trademarks from Beijing Deepcool Industries Co., Ltd.
 All rights reserved.
 Beijing Deepcool Industries Co., Ltd.
 MADE IN CHINA

